

Stantec Consulting Services Inc.
 141 Portland Street
 Boston, MA U.S.A.
 02114
 Tel: 617.523.8103
 Fax: 617.523.4333
 www.stantec.com

Consultants

Legend

PREPARED FOR:
 PROJECT OF SIGNIFICANT
 IMPACT (PSI)
 04/10/08

NOT FOR
 CONSTRUCTION

Owner:
 NDNE LOWER FALLS LLC
 C/O NATIONAL DEVELOPMENT
 2310 WASHINGTON ST.
 NEWTON, MA 02462

Revision	By	Appt.	DD.MM.YY
MISC REVISIONS			04/10/08
MISC REVISIONS			02/25/08
DRB REVISIONS			01/29/08
Issued		By	Appt.
PSI SUBMISSION 12/14/07	CF/AT	RG/HH	12/14/07
File Name:			
Permit/Seal			

Project
 27 WASHINGTON STREET
 WELLESLEY, MA

LAYOUT AND MATERIALS PLAN

Title
 Project No. 210810389
 Scale 1"=30'-0"
 Drawing No. Revision
 L-1 3

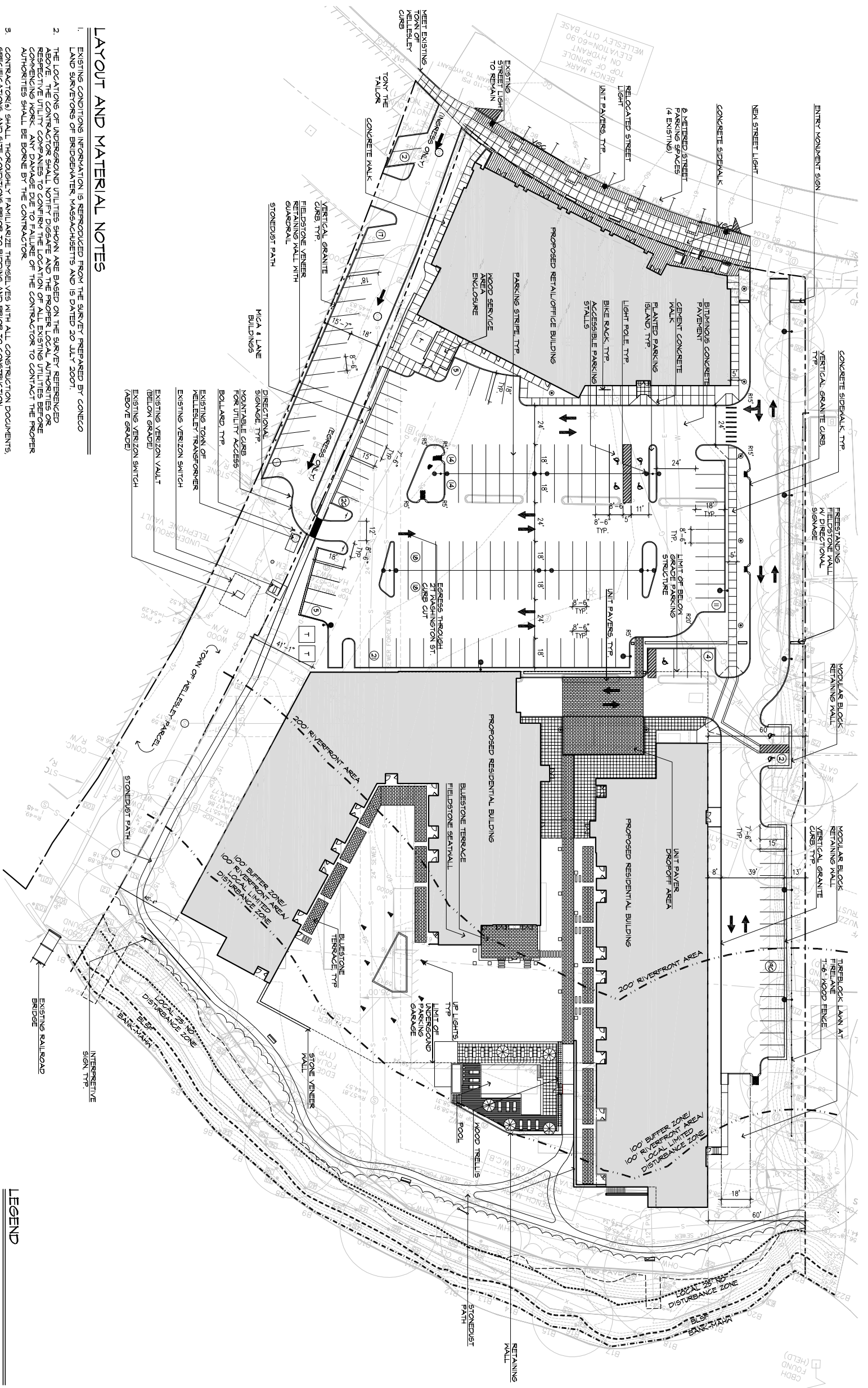

LAYOUT AND MATERIAL NOTES

- EXISTING CONDITIONS, INFORMATION IS REPRODUCED FROM THE SURVEY PREPARED BY CONECCO LAND SURVEYORS OF BRIDGEWATER, MASSACHUSETTS AND IS DATED 20 JULY 2007.
- THE LOCATIONS OF UNDERGROUND UTILITIES SHOWN ARE BASED ON THE SURVEY REFERENCED ABOVE. THE CONTRACTOR SHALL NOTIFY DISSEAT AND THE PROPER LOCAL AUTHORITIES OR RESPECTIVE UTILITY COMPANIES TO CONFIRM THE LOCATION OF ALL EXISTING UTILITIES BEFORE COMMENCING WORK. ANY DAMAGE DUE TO FAILURE OF THE CONTRACTOR TO CONTACT THE PROPER AUTHORITIES SHALL BE BORNE BY THE CONTRACTOR.
- CONTRACTOR(S) SHALL THOROUGHLY FAMILIARIZE THEMSELVES WITH ALL CONSTRUCTION DOCUMENTS, SPECIFICATIONS, AND SITE CONDITIONS PRIOR TO CONSTRUCTION.
- ANY DISCREPANCIES BETWEEN DRAWINGS, SPECIFICATIONS, AND SITE CONDITIONS SHALL BE REPORTED IMMEDIATELY TO THE OWNER'S REPRESENTATIVE FOR CLARIFICATION AND RESOLUTION PRIOR TO BIDDING OR CONSTRUCTION.
- ALL WORK CONDUCTED WITHIN PUBLIC RIGHT-OF-WAYS SHALL CONFORM TO THE REQUIREMENTS AND SPECIFICATIONS OF THE TOWN OF WELLESLEY AND THE MASSACHUSETTS HIGHWAY DEPARTMENT.
- SEE ARCHITECTURAL DRAWINGS FOR EXACT DIMENSIONS AND ALL DETAILS CONTINGUOUS TO THE DRAWINGS, ROOF DRAINING, ETC.
- ACCESSIBLE CURB RAMP SHALL BE PER THE MASSACHUSETTS ARCHITECTURAL ACCESS BOARD (MAAB) AND THE AMERICANS WITH DISABILITIES ACT (ADA) ACCESSIBILITY GUIDELINES, WHICHEVER IS MORE STRINGENT.
- THE FOLLOWING LAYOUT CRITERIA SHALL CONTROL UNLESS OTHERWISE NOTED ON THE PLAN.
 ALL DIMENSIONS ARE TO OUTSIDE FACE OF BUILDING.
 ALL DIMENSIONS ARE TO CENTER OF CURB AT GUTTER LINE.
 ALL TIES ARE TO PROPERTY LINES ARE PERPENDICULAR TO THE PROPERTY LINE UNLESS OTHERWISE NOTED.
- FOR LAYOUT AND DIMENSIONING OF BUILDINGS, SEE ARCHITECTURAL DRAWINGS.
- SCREENED IMAGES SHOWN EXISTING CONDITIONS, WHERE EXISTING CONDITIONS LIE UNDER OR ARE IMPEDED UPON BY PROPOSED BUILDINGS AND/OR SITE ELEMENTS, THE EXISTING CONDITION WILL BE REMOVED, ABANDONED AND/OR CAPPED OR DEMOLISHED AS REQUIRED.

PARKING SUMMARY

	PROVIDED	REQUIRED
RESIDENTIAL UNDERGROUND	223	282
RESIDENTIAL SURFACE	54*	
RETAIL	84	61
TOTAL:	366 (3,001,000 S.F.)	349 (2,391,000 S.F.)

*INCLUDES 34 SPACES FROM RETAIL SURFACE PARKING AREA

LEGEND

- ◆ NEW OR RELOCATED STREET LIGHTS
- POLE LIGHT TYPE I (8' FIXTURE HEIGHT)
- POLE LIGHT TYPE II (8' FIXTURE HEIGHT)
- POLE LIGHT TYPE III (14' FIXTURE HEIGHT)
- BOLLARD LIGHT
- LANDSCAPE UP LIGHT
- INTERPRETIVE SIGN
- SEATING BENCH

